

Avoid personal injury and damage to your system, by observing all warnings & cautions provided. We strongly recommend that you refer to the accompanying manuals for more detailed information about your system.

1 Introduction

This custom device has been exclusively designed for: _____

As this is a prescribed system, it should **NOT** be used by any person other than that stated. This device should only be used in conjunction with a support device prescribed by Enable Ireland.

The life span of this device depends on the amount of use & the variation of user's needs. It is recommended that devices be reviewed at regular intervals. (6 months for children & 1 year for adults).

SeatTech Ref. Details:

Technician: _____
Clinician: _____
ST SN: _____ Dol: ____/____/____

If problems arise with the equipment that your seating system is used with, please contact the manufacturer of this equipment directly.

Manufacturer and Model: _____
SN: _____

In the design production and supply of this device Enable Ireland SeatTech Sandymount Ave., Dublin 4 has made every effort to conform to the Essential Requirements, Schedule I of S.I No. 252, the European Communities Medical Devices Regulations, 1994.

The essential requirements have not been met in the following areas: _____

... on the grounds that: _____

2 Locking Systems

SeatTech seating systems, can be completely/partly removable for cleaning & transport purposes. Different locking methods are used to secure these system into place. Marked boxes indicate which locking methods are relevant to your system.

Straps

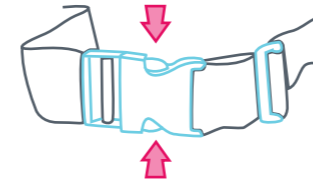

Swivel Locks

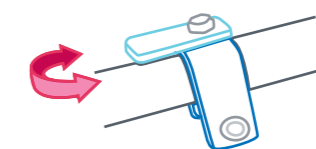

Pin Locks

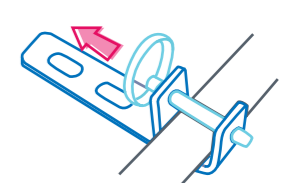

Velcro

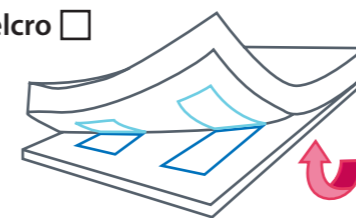

Push Locks

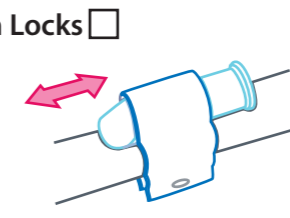

Turn release

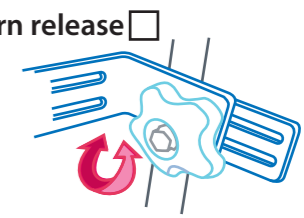

3 Assembly/Disassembly

The illustrated steps below describe how to disassemble a seating system. This procedure should be reversed for assembly. This is a generic guide for assembly/disassembly of SeatTech systems. The arrows placed on your system identify the locations where relevant backrest/seat cushion brackets should be placed. The specific 'type' of device positioned on your chair is identified below under each section. Detailed information on each 'type' will be found in the accompanying SeatTech Manual.

1) Remove **Head Support & Tray**



Type: _____
ST #: _____
Type: _____
ST #: _____

2) Remove **Arm Support & Hip Supports**



Type: _____
ST #: _____
Type: _____
ST #: _____

3) Remove **Back Support & Trunk Laterals**

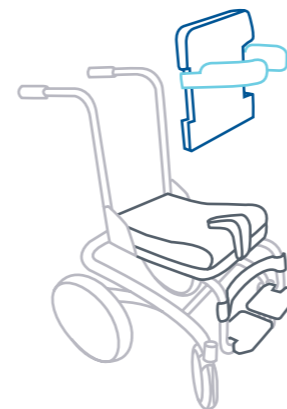

Type: _____
ST #: _____
Type: _____
ST #: _____

Chest Harness: _____

4) Remove **Pommel & Seat**

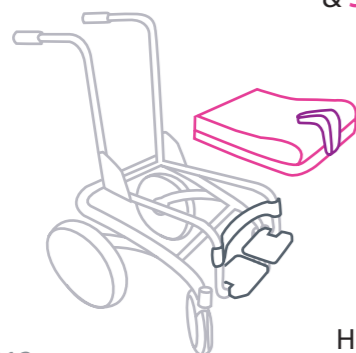

Type: _____
ST #: _____
Type: _____
ST #: _____

Hip Strap: _____

5) Remove **Lower Leg Support**

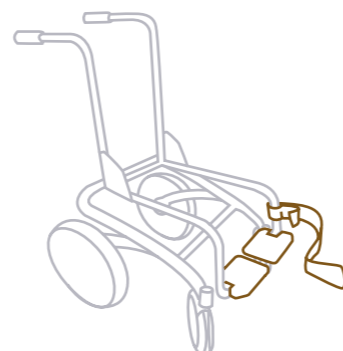

- Foot Cup: Type: _____ ST #: _____
- Foot Straps: Type: _____ ST #: _____
- Foot Pad: Type: _____ ST #: _____
- Ankle Straps: Type: _____ ST #: _____
- Calf Strap: Type: _____ ST #: _____

Miscellaneous: _____ ST# _____
_____ ST# _____
_____ ST# _____

WARNING: Fire/Heat



Under no circumstances should any part of the seating system be exposed to excessive heat or naked flame, matches or cigarettes.



If you have any queries or comments please contact SeatTech immediately.

Tel: (0)1 2615926
Fax: (0)1 2695816

Email: seatech@enableireland.ie
Web: www.enableireland.ie

Address:
SeatTech,
Enable Ireland,
Sandymount Av.
Dublin 4.

Action on Disability

Enable Ireland

WARNING: STRAPS AND HARNESSSES

Care must be taken to ensure that any strap or harness be fastened correctly so that they do not present a choking hazard on or around the throat area.

1) Secure the user in the seating system. Close Pelvic and/or Groin Strap first; this minimizes the risk of the user sliding down within the seat.

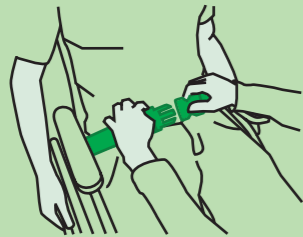

2) To ensure throat clearance, always secure the lower retaining straps of a Chest Harness first.



3) The over-shoulder/upper straps of the Chest Harness are the last to be adjusted.



All straps and harnesses used in a seating system should be regularly checked for position and potential problems

4 Care and Cleaning

In order to preserve the quality and shape of your seating system, the following instructions should be followed:

1) Take removable parts off the wheelchair.



2) Removable covers are supplied. Only the outer cover is to be taken off for cleaning.

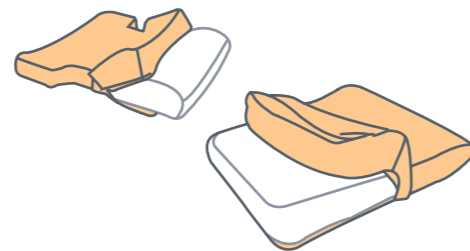

3) Continued..

- Covers should NOT be ironed
- Covers should NOT be dry cleaned



4) Brush down the remaining segments.

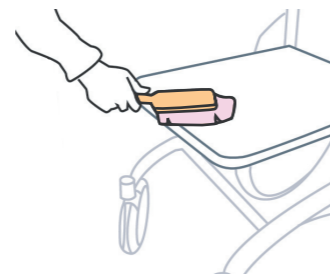

6) Check that all components are intact and are in full working order. Please take note of any damage and report it to your therapist or SeatTech.



7) Re-assemble the seating system onto the support device.



3) Clean removable cushion covers.

- Covers may be laundered at □50°c / □30°c.
- Covers can be tumble-dried.

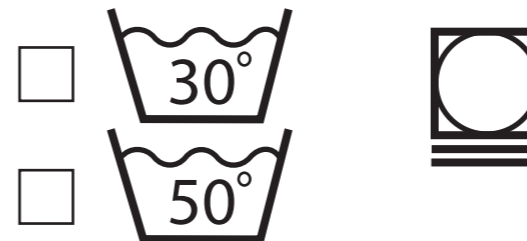

5) Clean non-removable covers by wiping with a soft cloth moistened with water containing a neutral detergent.

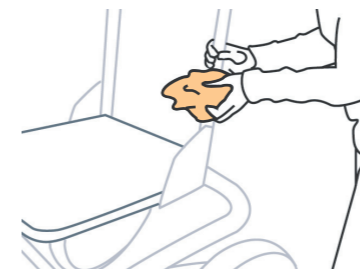

8) Ensure that all locking mechanisms are operating properly.

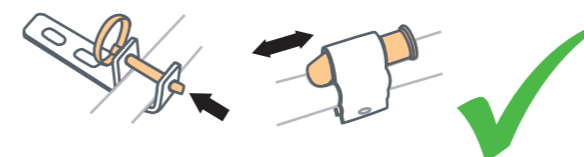

WARNING: TRANSPORT

Where possible it is recommended that wheelchair occupants transfer from their seating systems to a car/bus seat.

Unrestrained wheelchairs and seating components have the potential to cause serious injury to the occupant and/or other occupants of the vehicle.

Unoccupied Chairs

An unoccupied wheelchair and seating system must be secured within a vehicle using suitable strapping.

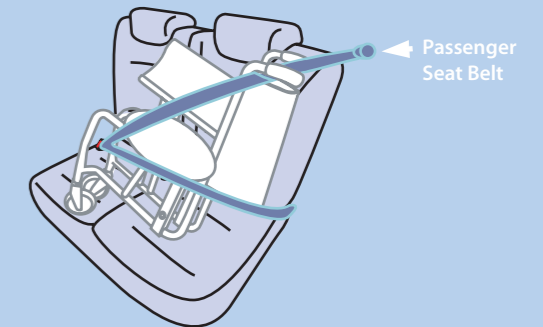

Occupied Chairs

Approved vehicle mounted Wheelchair Tie-downs and Occupant Restraint Systems (WTORS) should be used to secure the wheelchair and occupant.



Lap belts, Chest Harnesses and Pommels attached to wheelchairs or seating units are provided to assist posture and are NOT vehicle occupant restraints. Their use during transport could create a hazard.

Head Supports, where provided, should be used during transport. The minimum distance a headrest should be from a head is 1cm.

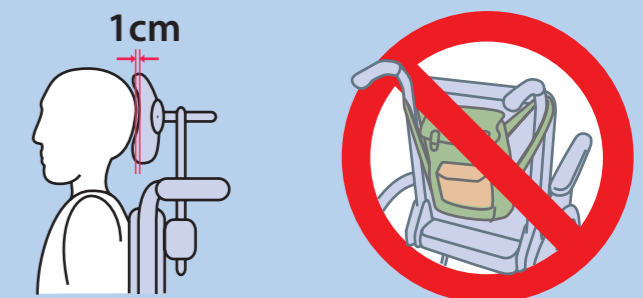

Bags, trays and other accessories should be removed from the wheelchair during transport.